

1036 EMISSIONS LABEL

1058 OPERATOR'S MANUAL

1330 REPAIR MANUAL

1319 WARNING LABEL

WARNING	
	Read and follow Operating instructions before running engine.
	Gasoline is flammable. Allow engine to cool at least 2 minutes before refueling.
	Engines emit carbon monoxide. DO NOT run in enclosed area.
	Muffler area temperature may exceed 150°F. Do not touch hot parts.
REQUIRED when replacing parts with warning labels affixed.	

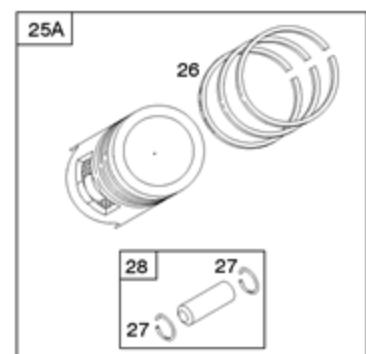
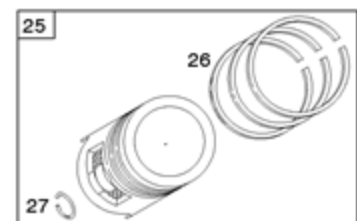
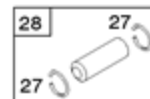
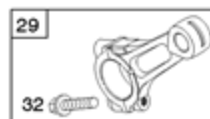
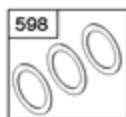
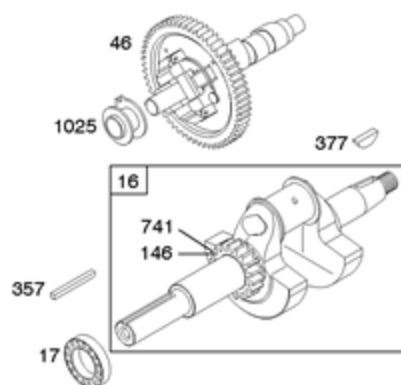

Ref #	Part #	Description	Qty	Context Note	Foot Note
1	692178	Cylinder Assembly		Used After Code Date 97043000	
1	807521	Cylinder Assembly		Used Before Code Date 97050100	
2	808534	Kit-Bushing/Seal		(Magneto Side) Used After Code Date 97043000	
2	807687	Kit-Bushing/Seal		(Magneto Side) Used Before Code Date 97050100	
3	805101S	Seal-Oil		(Magneto Side)	
8	808984	Breather Assembly			
9	844986	Gasket-Breather			
10	805194	Screw		(Breather Assembly) Used Before Code Date 90111500	
10	690751	Screw		(Breather Assembly) Used After Code Date 90111400	
11	691556	Tube-Breather			
11A	806083S	Tube-Breather			
15	690946	Plug-Oil Drain		(External 7/16" Sq)	
15	691680	Plug-Oil Drain		(Internal 3/8" Sq)	
16		Crankshaft		(NO LONGER AVAILABLE) Used Before Code Date 97050100	
16	692161	Crankshaft		Used After Code Date 97043000	
17	843827	Bearing-Ball			
25	843952	Piston Assembly		(Standard) Used After Code Date 07122300	
25	843956	Piston Assembly		(Standard) Used After Code Date 07122300	
25A	843951	Piston Assembly		(Standard) Used Before Code Date 07122400	
25A	843958	Piston Assembly		(.020" Oversize) Used Before Code Date 07122400	
26		Ring Set		(For Replacement Rings Order Ref #25A) Used Before Code Date 07122400	
26	843953	Ring Set		(Standard) Used After Code Date 07122300	
26	843957	Ring Set		(.020" Oversize)	

27	690683	Lock-Piston Pin	
28	807621	Pin-Piston	(Standard) Used Before Code Date 07122400
28	844541	Pin-Piston	(Standard) Used After Code Date 07122300
29	807900S	Rod-Connecting	(Standard)
32	690698	Screw	(Connecting Rod)
46	845649	Camshaft	
146	691639	Key-Timing	
357	691483	Key-Drive Pulley	
377	808095	Key-Woodruff	
572	690686	Baffle-Breather	Used Before Code Date 04060100
598	807625	Shim-End Play	(Crankshaft or Camshaft Bearing)
601	691038	Clamp-Hose	
706	805484	Washer	(Breather Assembly) Used Before Code Date 90111500
718	806469	Pin-Locating	
718A	805102	Pin-Locating	Used Before Code Date 90091100
741	691530	Gear-Timing	
1025	690689	Spool-Governor	
1036		Label-Emissions	(Available From A Briggs & Stratton Authorized Dealer)
1058	276344TRI	Operator's Manual	
1319	794467	Label-Warning	
1330	272144	Repair Manual	